

NOTE:-
 1) ALL DIMENSIONS ARE IN MM
 2) RAW MATLS:- FLATS, SQ. BAR CONFIRM TO IS: 2062, GR-"A"
 3) FINISH: HOT DIP GALVANISED AS PER IS: 2629 UPTO 100 MICRONS ON AS AVERAGE FLAT SURFACE.

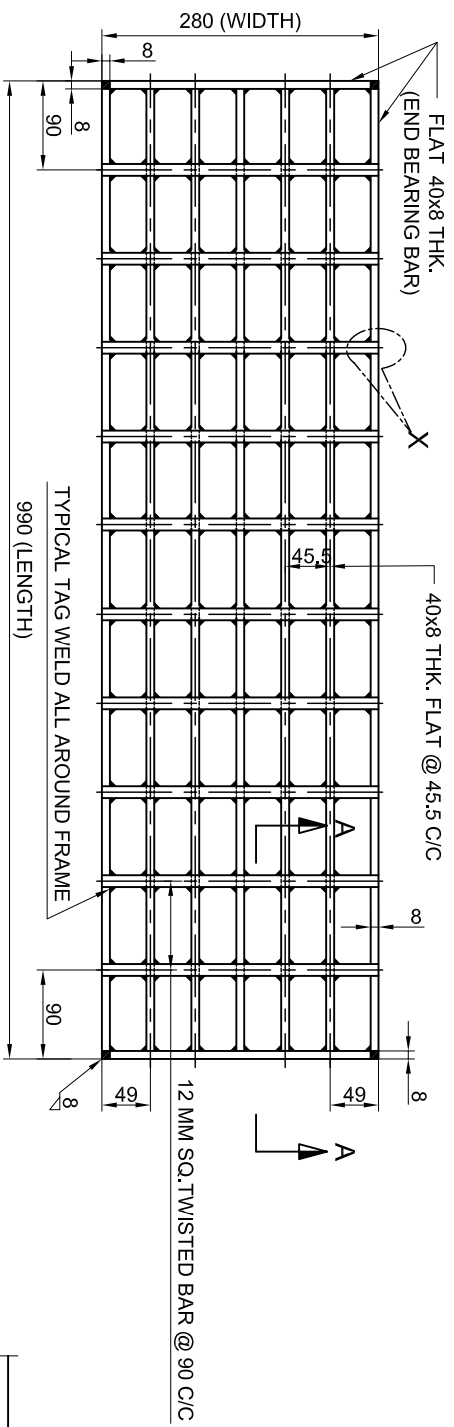

SCALE-1:5

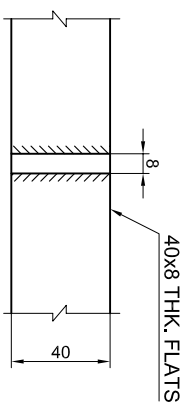

DETAIL-X
SCALE-1:2

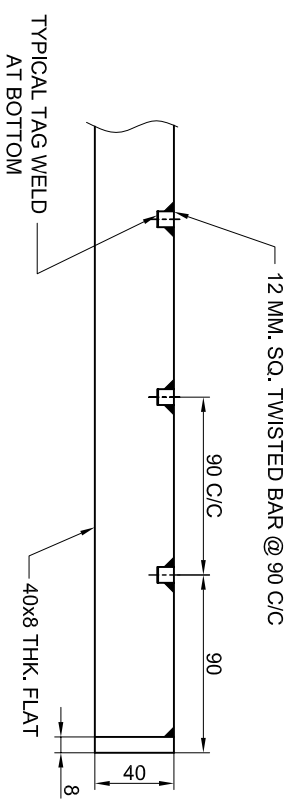

SECTION-AA
SCALE-1:2.5

GRATING DETAIL

LENGTH	WIDTH	MATERIAL	WT. IN Kgs. (APX.)
990	280	IS:2062 GR "A"	18.8 ±5%

MATERIAL:- MILD STEEL FABRICATION FOLLOWED BY HOT DEEP GALVANIZED WITH GALVANIZATION THICKNESS OF MINIMUM- 100 MICRONS.

DRAWING MAY BE USED IN WHOLE OR PART, PROVIDED THE (IFFCO) NAME AND LOGO ARE VISIBLE IN ANY REPRODUCTION.

IFFCO		INDIAN FARMERS FERTILISER CO-OP.LTD.	
PARADEEP - ORISSA - INDIA		PLANT : U&O (PLANNING)	
DRN S.SWAIN	4.07.16	PLANT	FORM
CHD R.K.BARIK	9.07.16	06	DB
APD D.K.NEMA	19.07.16	12	21
SCALE - AS SHOWN		22	10
CODE 06DB12210 DRAWING NO.		NUMBER	SHEET
		3	4
DETAILS OF TYPICAL MANUAL GRATING SIZE-(990X280) (HEAVY DUTY)		REV.	2